

# BLDC MOTOR SERIES

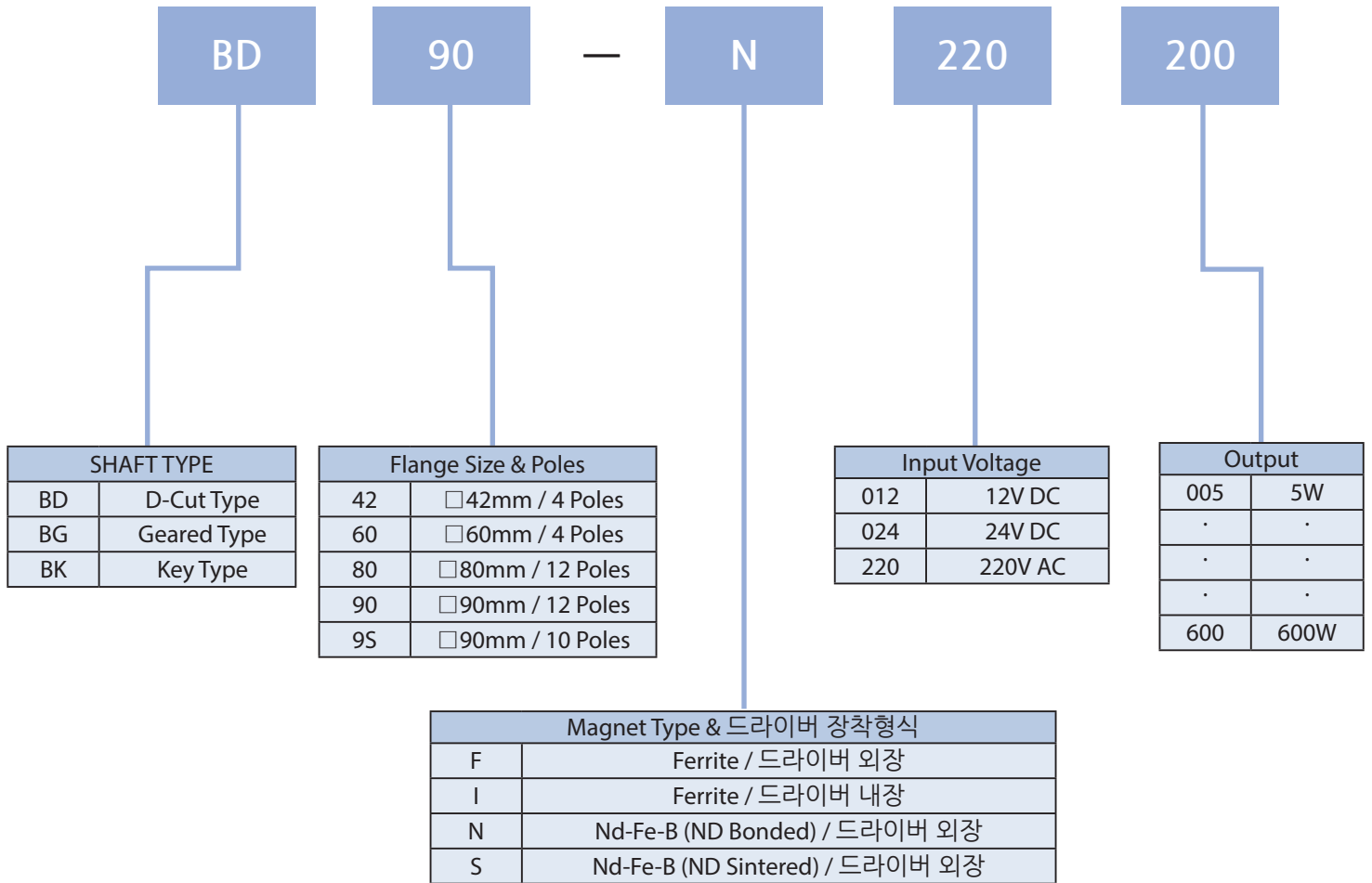

BLDC MOTOR D-CUT TYPE  
BLDC MOTOR GEARED TYPE

# BLDC Motor Coding



# BLDC42 SERIES

## BD42

- ◆ □42mm
- ◆ 12V/24V
- ◆ 5W/7W
- ◆ D-CUT TYPE SHAFT

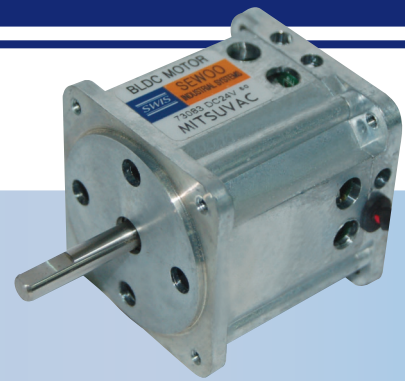

### Specifications

MODEL		BD42					
		I012005	I012007	I024007	F012005	F012007	F024007
Rated Voltage	V	12	12	24	12	12	24
Rated Output	W	5	7	7	5	7	7
Rated Current	A	1.0	1.0	0.5	1.0	1.0	0.5
Rated Speed	rpm	2000	2400	2400	2000	2400	2400
Rated Torque	kgf-cm	0.26	0.28	0.28	0.26	0.28	0.28
Weight	kg	0.25	0.25	0.25	0.25	0.25	0.25
Applicable Drive		☒ Driver Inside(내장형)			SBDO-01(외장형)		

☒ Driver inside type is not adjustable for speed

●●●●●▶ The specifications above are subject to change for enhancement of product performance, Without any prior notice.

### Speed-Torque Curve

BD42-I012005

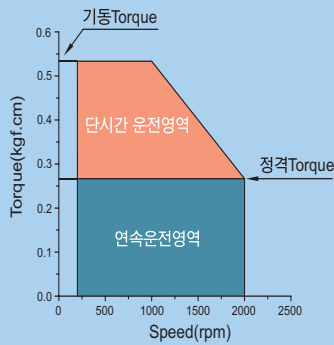

BD42-I012007

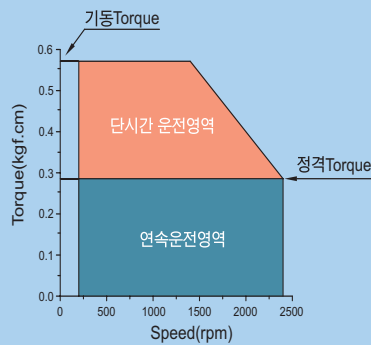

BD42-I024007

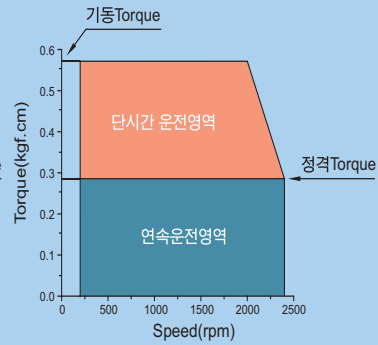

BD42-F012005

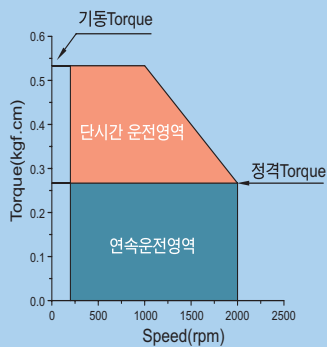

BD42-F012007

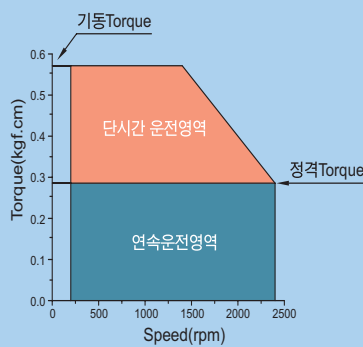

BD42-F024007

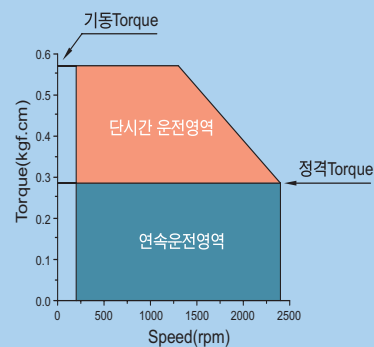

Dimension

BD42 내장형

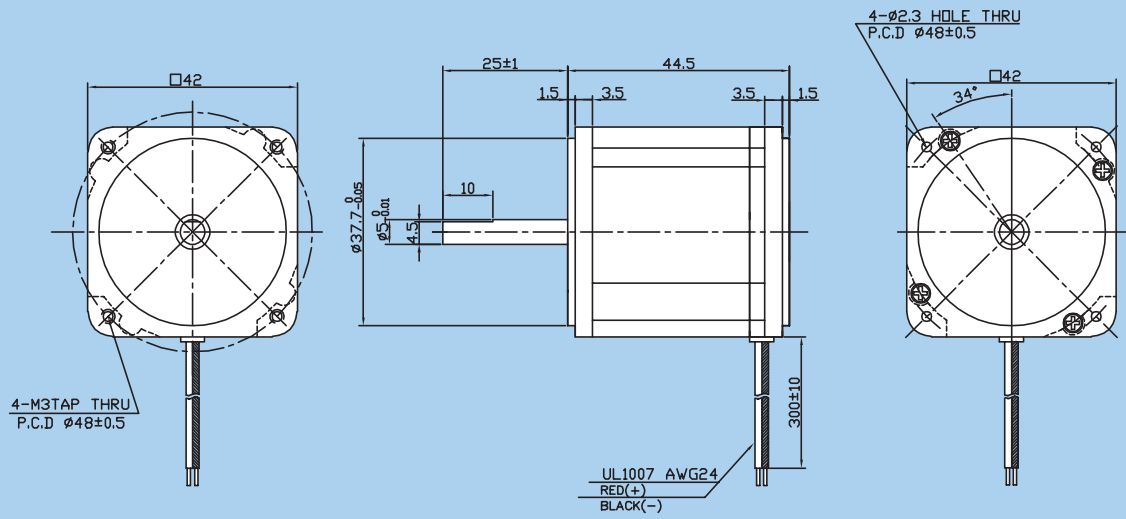

BD42 외장형

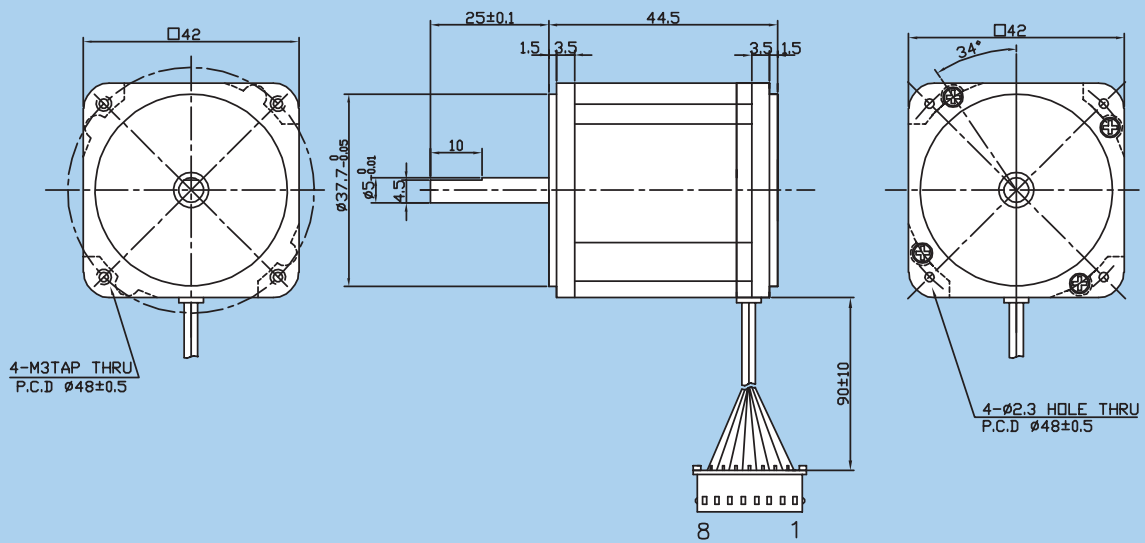

CONNECTOR(CHB0640-8)

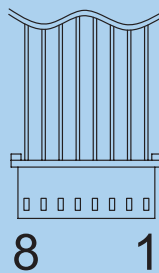

CONNECTOR  
: CHB0640-8

PIN No.	Cable Color	LeadWire	Remark
1	WHITE	AWG 24	Hw
2	BROWN	AWG 24	Hv
3	GRAY	AWG 24	Hu
4	BLACK	AWG 24	GND
5	ORANGE	AWG 24	Vcc
6	YELLOW	AWG 24	U
7	RED	AWG 24	V
8	BLUE	AWG 24	W

# BLDC60 SERIES

## BD60

- ◆ □60mm
- ◆ 12V/24V/220V
- ◆ 10W/15W/20W/40W/50W/60W/80W
- ◆ D-CUT, GEAR TYPE SHAFT

밀폐형

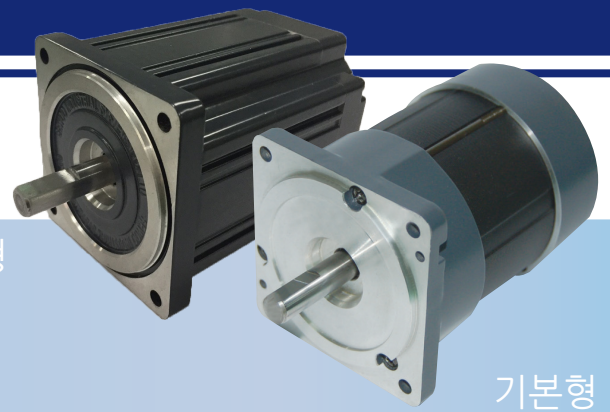

기본형

### Specifications

MODEL		BD60								
		N012010	N012015	N012020	N024020	N024040	N024050	N220040	N220060	N220080
Rated Voltage	V	12			24			220		
Rated Output	W	10	15	20	20	40	50	40	60	80
Rated Current	A	1.4	2.1	2.8	1.4	2.3	3.2	0.7	0.9	1.1
Rated Speed	rpm	3000								
Rated Torque	kgf-cm	0.3	0.4	0.6	0.6	1.3	1.6	1.3	1.9	2.5
Weight	kg	0.5	0.6	0.7	0.5	0.6	0.7	0.5	0.6	0.7
Applicable Drive		SBDM-05A						□ SBDSMA-02A □ SBDSMI-03D □ SBDSMS-03D		

□ Before placing an order, consult with manufacturer and place of purchase

●●●●●▶ The specifications above are subject to change for enhancement of product performance, Without any prior notice.

### Speed-Torque Curve

BD60-N012010

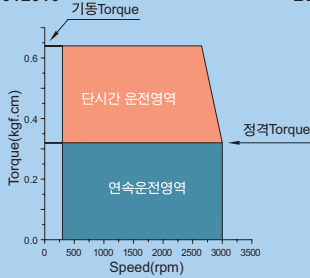

BD60-N012015

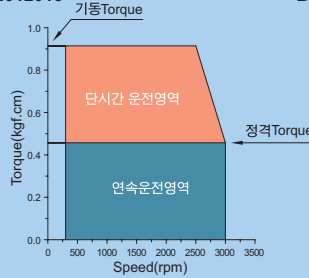

BD60-N012020

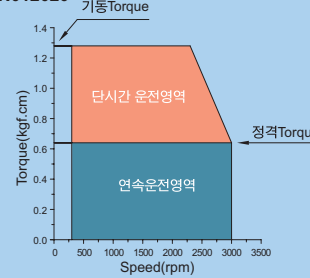

BD60-N024020

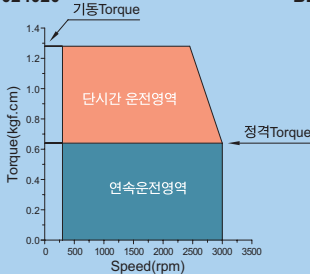

BD60-N024040

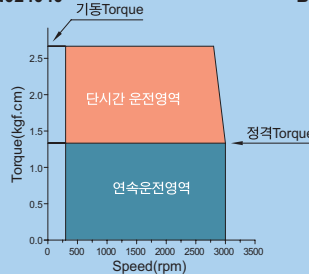

BD60-N024050

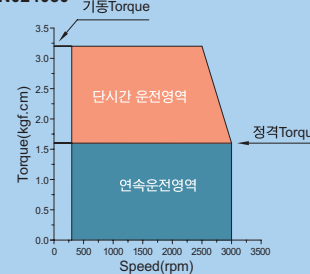

BD60-N220040

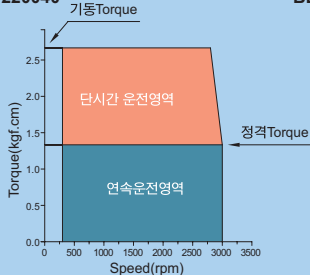

BD60-N220060

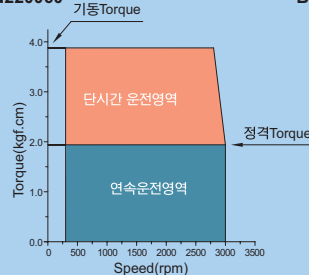

BD60-N220080

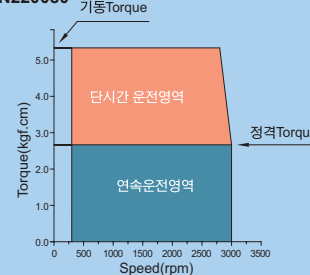

Dimension

☐ 밀폐형 SPEC 별도 협의 바랍니다.

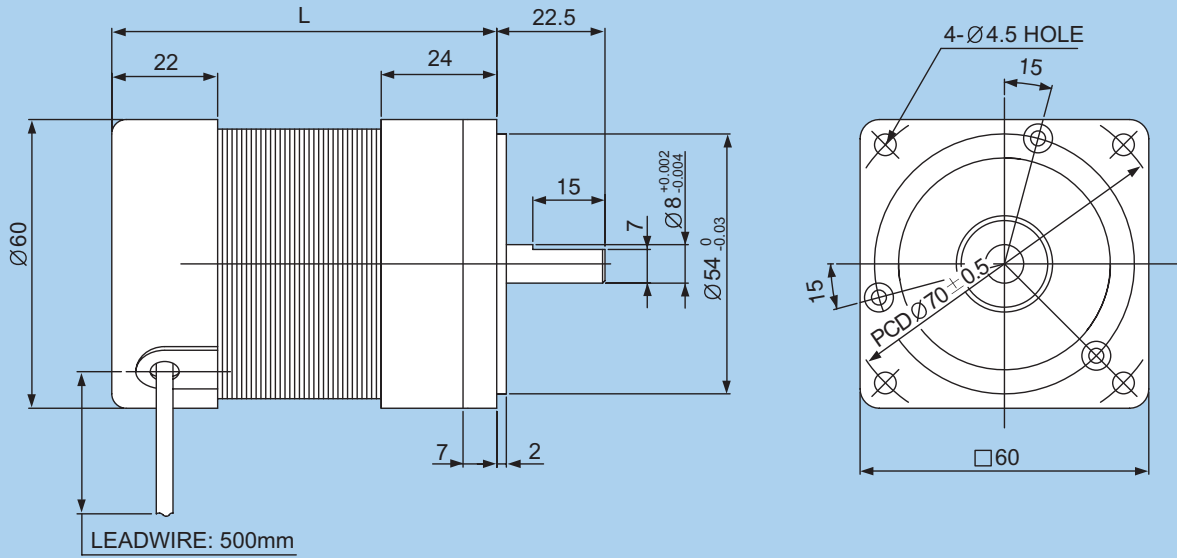

CONNECTOR  
: MOLEX 5557-08  
(SBDM-05A)

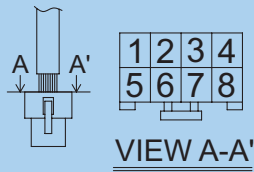

CONNECTOR(5557-8)

PIN No.	Cable Color	LeadWire	Remark
1	ORANGE	AWG 24	Vcc
2	RED	AWG 20	U
3	YELLOW	AWG 20	V
4	BLUE	AWG 20	W
5	BLACK	AWG 24	GND
6	WHITE	AWG 24	Hu
7	GREEN	AWG 24	Hv
8	BROWN	AWG 24	Hw

CONNECTOR  
: MOLEX 5557-12  
(AC 전원용)

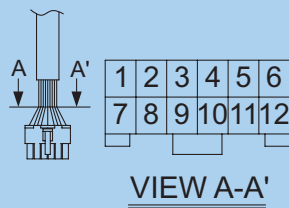

CONNECTOR(5557-12)

PIN No.	Cable Color	LeadWire	Remark
1	BLUE	AWG 20	W
2			
3			
4	BROWN	AWG 24	Hw
5	GREEN	AWG 24	Hv
6	WHITE	AWG 24	Hu
7	YELLOW	AWG 20	V
8	RED	AWG 20	U
9	GRE/YEL	AWG 20	SHIELD
10			
11	ORANGE	AWG 24	Vcc
12	BLACK	AWG 24	GND

L	MODEL
60	N012010 / N024020 / N220040
70	N012015 / N024040 / N220060
80	N012020 / N024050 / N220080

# BLDC80 SERIES

## BD80

- ◆ □80mm
- ◆ 12V/24V/220V
- ◆ 25W/40W/60W/80W/100W
- ◆ D-CUT,GEAR TYPE SHAFT

밀폐형



기본형

### Specifications

MODEL		BD80								
		N012025	N012040	N012060	N024040	N024060	N024080	N220060	N220080	N220100
Rated Voltage	V	12			24			220		
Rated Output	W	25	40	60	40	60	80	60	80	100
Rated Current	A	3.0	4.5	7.0	2.1	3.1	4.2	0.7	0.9	1.1
Rated Speed	rpm	3000								
Rated Torque	kgf-cm	0.8	1.3	1.9	1.3	1.9	2.5	1.9	2.5	3.2
Weight	kg	1.4	1.5	1.6	1.4	1.5	1.6	1.4	1.5	1.6
Applicable Drive		SBDM-05A	SBDM-10A		SBDM-05A		SBDM-10A	□ SBDSMA-02A □ SBDSMI-03D □ SBDSMS-03D		

□ Before placing an order, consult with manufacturer and place of purchase

The specifications above are subject to change for enhancement of product performance, Without any prior notice.

### Speed-Torque Curve

BD80-N012025

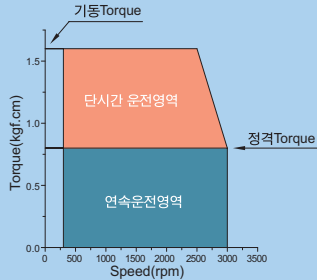

BD80-N012040

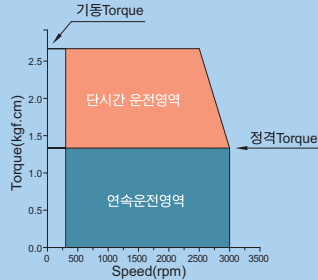

BD80-N012060

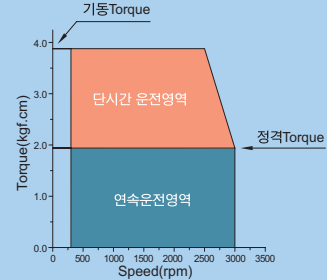

BD80-N024040

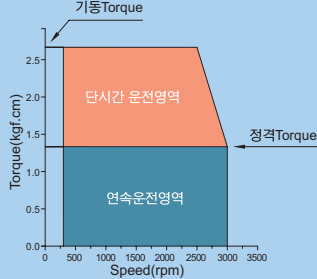

BD80-N024060

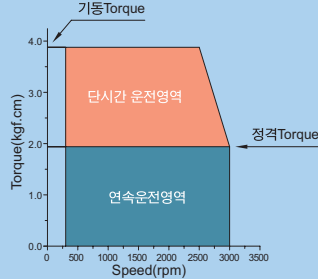

BD80-N024080

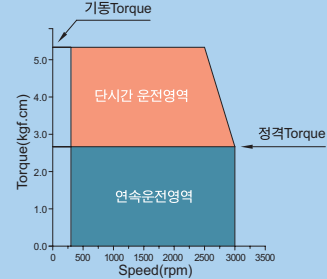

BD80-N220060



BD80-N220080

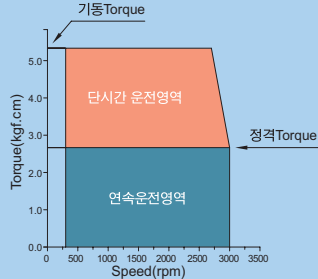

BD80-N220100

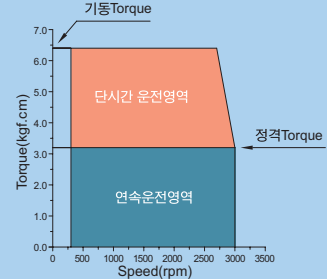

Dimension

☐ 밀폐형 SPEC 별도 협의 바랍니다.

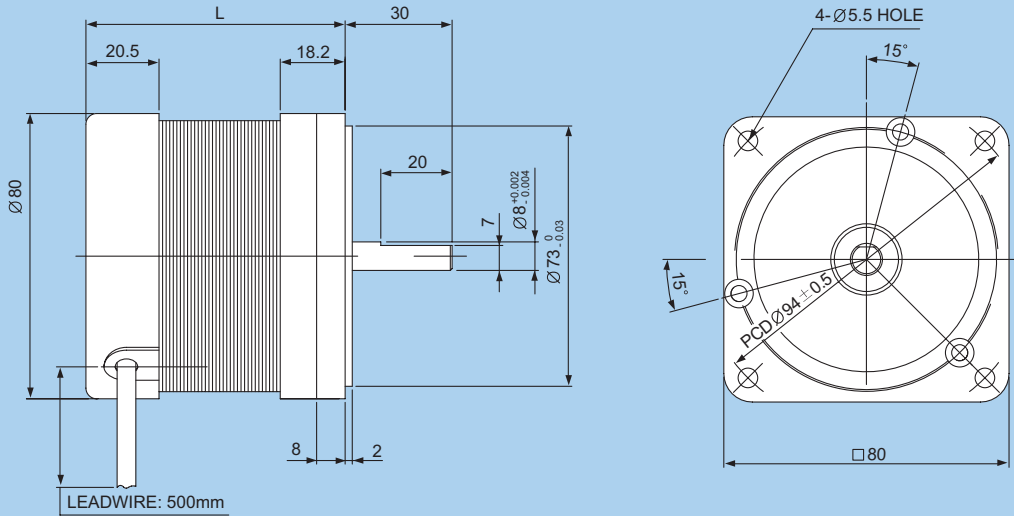

CONNECTOR : MOLEX 5557-08 (SBDM-05A)

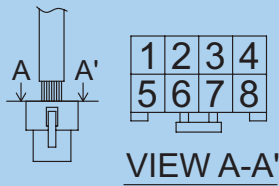

CONNECTOR(5557-8)

PIN No.	Cable Color	LeadWire	Remark
1	ORANGE	AWG 24	Vcc
2	RED	AWG 20	U
3	YELLOW	AWG 20	V
4	BLUE	AWG 20	W
5	BLACK	AWG 24	GND
6	WHITE	AWG 24	Hu
7	GREEN	AWG 24	Hv
8	BROWN	AWG 24	Hw

CONNECTOR(5557-12)

PIN No.	Cable Color	LeadWire	Remark
1	BLUE	AWG 20	W
2			
3			
4	BROWN	AWG 24	Hw
5	GREEN	AWG 24	Hv
6	WHITE	AWG 24	Hu
7	YELLOW	AWG 20	V
8	RED	AWG 20	U
9	GRE/YEL	AWG 20	SHIELD
10			
11	ORANGE	AWG 24	Vcc
12	BLACK	AWG 24	GND

CONNECTOR : MOLEX 5557-12 (AC 전원용)

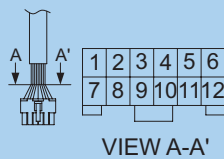

1. CONNECTOR(5264-05)

PIN No.	Cable Color	LeadWire	Remark
1	WHITE	AWG 24	Hu
2	GREEN	AWG 24	Hv
3	BROWN	AWG 24	Hw
4	BLACK	AWG 24	GND
5	ORANGE	AWG 24	Vcc

2. CONNECTOR

PIN No.	Cable Color	LeadWire	Remark
1	RED	AWG 16	U
2	YELLOW	AWG 16	V
3	BLUE	AWG 16	W

CONNECTOR : MOLEX 5264-05 (SBDM-10A)

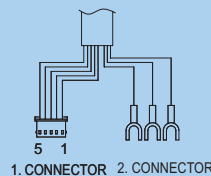

L	MODEL
52.7	N012025 / N024040 / N220060
62.7	N012040 / N024060 / N220080
72.7	N012060 / N024080 / N220100



# BLDC90 SERIES

## BD90

- ◆ □90mm
- ◆ 12V/24V/220V
- ◆ 40W/50W/60W/70W/100W/150W/200W
- ◆ D-CUT, GEAR TYPE SHAFT

밀폐형

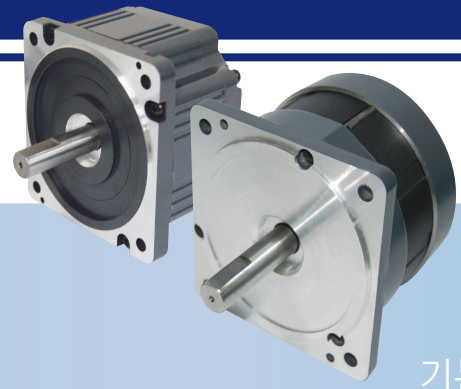

기본형

### Specifications

MODEL		BD90								
		N012040	N012060	N012070	N024050	N024100	N024150	N220100	N220150	N220200
Rated Voltage	V	12			24			220		
Rated Output	W	40	60	70	50	100	150	100	150	200
Rated Current	A	5.8	8.5	10	3.0	5.6	8.1	1.0	1.6	2.1
Rated Speed	rpm	3000								
Rated Torque	kgf-cm	1.3	1.9	2.2	1.6	3.2	4.8	3.2	4.8	6.3
Weight	kg	2.1	2.3	2.5	2.1	2.3	2.5	2.1	2.3	2.5
Applicable Drive		SBDM-10A			SBDM-05A	SBDM-10A	SBDM-25A	SBDSMA-02A SBDSMI-03D SBDSMS-03D	SBDSMI-03D SBDSMS-03D	

☐ Before placing an order, consult with manufacturer and place of purchase.

●●●●●▶ The specifications above are subject to change for enhancement of product performance, Without any prior notice.

### Speed-Torque Curve

BD90-N012040

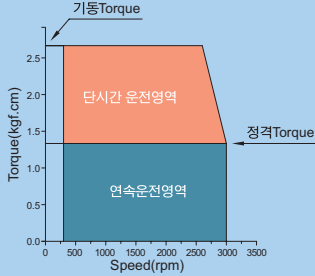

BD90-N012060

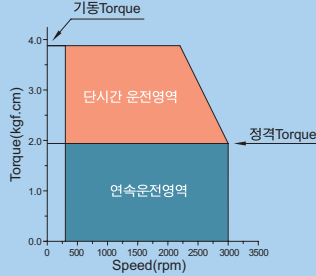

BD90-N012070

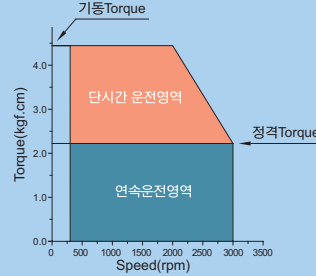

BD90-N024050

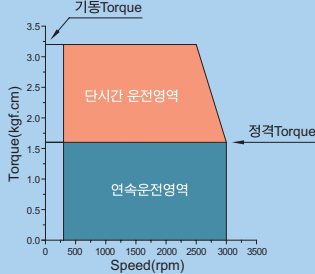

BD90-N024100

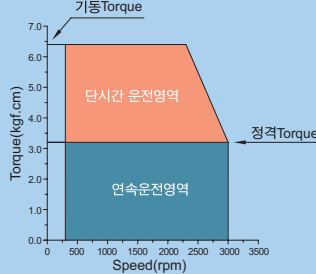

BD90-N024150

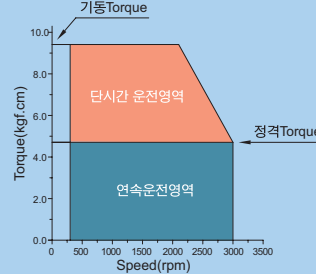

BD90-N220100

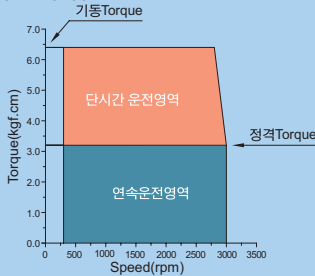

BD90-N220150

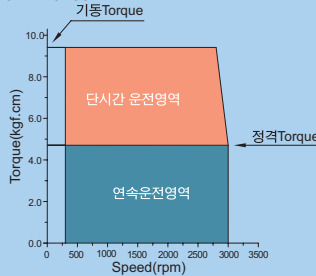

BD90-N220200

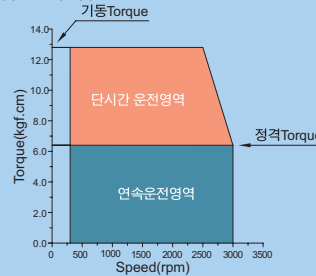

Dimension

☐ 밀폐형 SPEC 별도 협의 바랍니다.

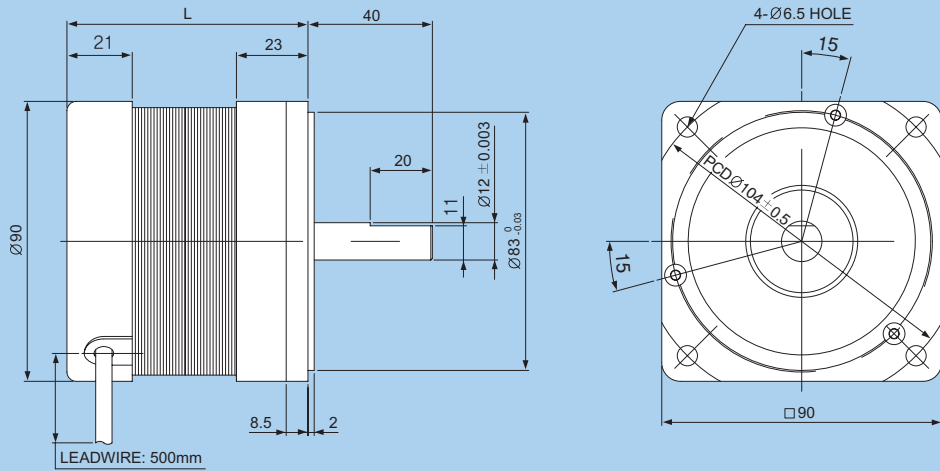

CONNECTOR : MOLEX 5557-08 (SBDM-05A)

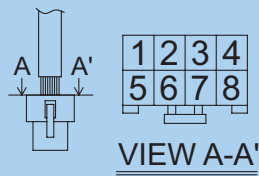

CONNECTOR(5557-8)

PIN No.	Cable Color	LeadWire	Remark
1	ORANGE	AWG 24	Vcc
2	RED	AWG 20	U
3	YELLOW	AWG 20	V
4	BLUE	AWG 20	W
5	BLACK	AWG 24	GND
6	WHITE	AWG 24	Hu
7	GREEN	AWG 24	Hv
8	BROWN	AWG 24	Hw

CONNECTOR(5557-12)

PIN No.	Cable Color	LeadWire	Remark
1	BLUE	AWG 20	W
2			
3			
4	BROWN	AWG 24	Hw
5	GREEN	AWG 24	Hv
6	WHITE	AWG 24	Hu
7	YELLOW	AWG 20	V
8	RED	AWG 20	U
9	GRE/YEL	AWG20	SHIELD
10			
11	ORANGE	AWG 24	Vcc
12	BLACK	AWG 24	GND

CONNECTOR : MOLEX 5557-12 (AC 전원용)

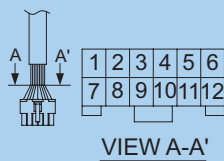

1. CONNECTOR(5264-05)

PIN No.	Cable Color	LeadWire	Remark
1	WHITE	AWG 24	Hu
2	GREEN	AWG 24	Hv
3	BROWN	AWG 24	Hw
4	BLACK	AWG 24	GND
5	ORANGE	AWG 24	Vcc

2. CONNECTOR

PIN No.	Cable Color	LeadWire	Remark
1	RED	AWG 16	U
2	YELLOW	AWG 16	V
3	BLUE	AWG 16	W

CONNECTOR : MOLEX 5264-05 (SBDM-10A/25A)

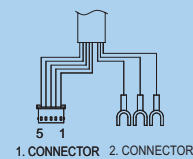

L	MODEL
57.5	N012040 / N024050 / N220100
67.5	N012060 / N024100 / N220150
77.5	N012070 / N024150 / N220200

# BLDC90 SERIES

## BK90 (고출력형)

- ◆ □ 90mm
- ◆ 12V/24V/220V
- ◆ 100W/120W/150W/200W/250W/300W/400W/500W/600W
- ◆ KEY TYPE SHAFT



### Specifications

MODEL		BK90 (고출력형)									
		S012100	S012120	S012150	S024200	S024250	S024300	S220300	S220400	S220500	S220600
Rated Voltage	V	12			24			220			
Rated Output	W	100	120	150	200	250	300	300	400	500	600
Rated Current	A	13.5	15.8	19.5	11.9	14.8	17.8	2.9	3.6	4.6	5.5
Rated Speed	rpm	3000									
Rated Torque	kgf-cm	3.2	3.9	4.8	6.3	7.9	9.5	9.5	13.0	16.2	19.5
Weight	kg	2.2	2.5	2.8	2.2	2.5	2.8	2.2	2.2	2.5	2.8
Applicable Drive		SBDM-25A						SBDSMD-05D			

The specifications above are subject to change for enhancement of product performance, Without any prior notice.

### Speed-Torque Curve

BK90-S012100

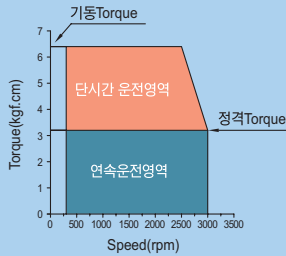

BK90-S012120

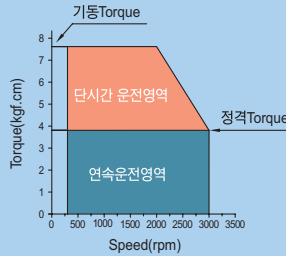

BK90-S012150

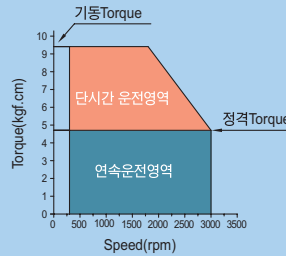

BK90-S024200

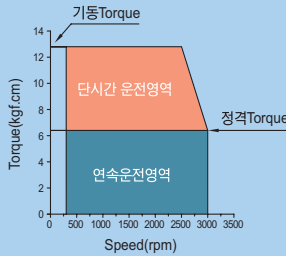

BK90-S024250

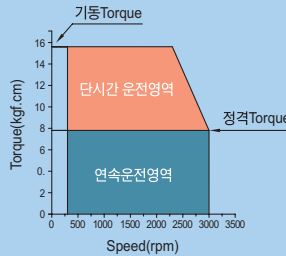

BK90-S024300

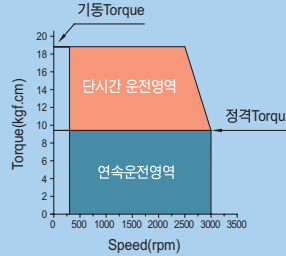

BK90-S220300

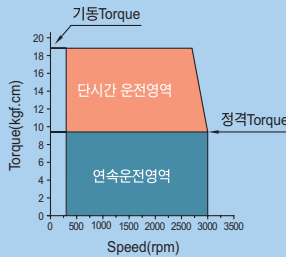

BK90-S220400

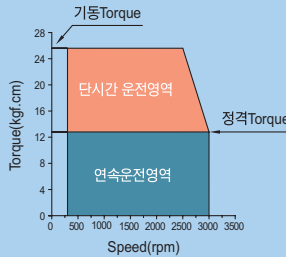

BK90-S220500

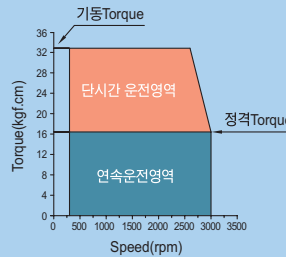

BK90-S220600

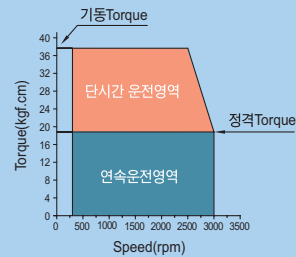

Dimension

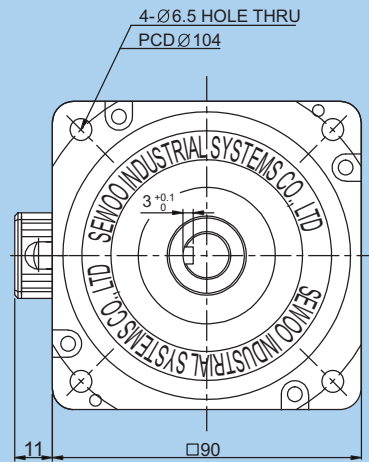
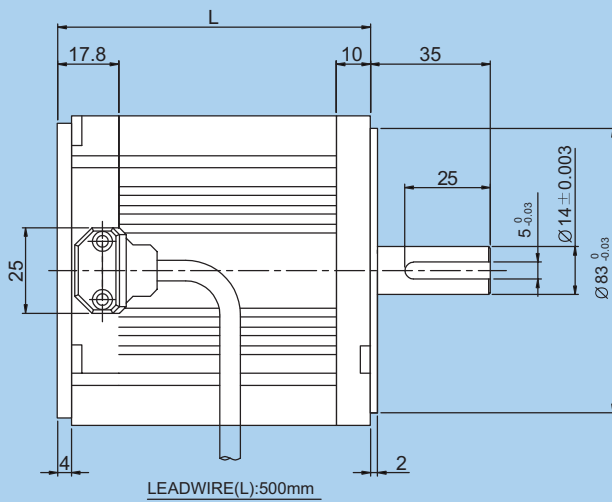

CONNECTOR  
: MOLEX 5557-12  
(AC 전원용)

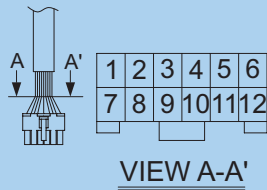

CONNECTOR(5557-12)

PIN No.	Cable Color	LeadWire	Remark
1	BLUE	AWG 20	W
2			
3			
4	BROWN	AWG 24	Hw
5	GREEN	AWG 24	Hv
6	WHITE	AWG 24	Hu
7	YELLOW	AWG 20	V
8	RED	AWG 20	U
9	GRE/YEL	AWG20	SHIELD
10			
11	ORANGE	AWG 24	Vcc
12	BLACK	AWG 24	GND

CONNECTOR  
: MOLEX 5264-05  
(SBDM-25A)

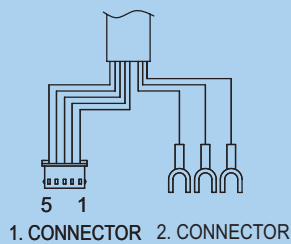

1. CONNECTOR(5264-05)

PIN No.	Cable Color	LeadWire	Remark
1	WHITE	AWG 24	Hu
2	GREEN	AWG 24	Hv
3	BROWN	AWG 24	Hw
4	BLACK	AWG 24	GND
5	ORANGE	AWG 24	Vcc

2. CONNECTOR

PIN No.	Cable Color	LeadWire	Remark
1	RED	AWG 14	U
2	YELLOW	AWG 14	V
3	BLUE	AWG 14	W

L	MODEL
81.3	S220300 / S220400
91.3	S012100 / S024200 / S220500
101.3	S012120/S012150/S02450/S220600
111.3	S024300

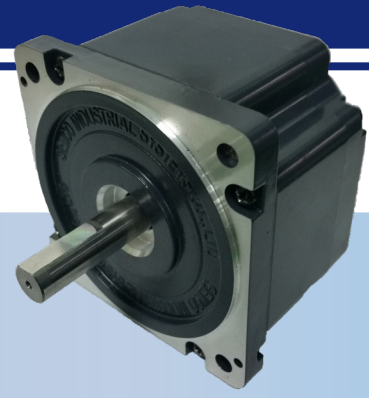

## BD9S

- ◆ □90mm
- ◆ 24V/220V
- ◆ 100W/150W/200W/250W/350W
- ◆ D-CUT,GEAR TYPE SHAFT

### Specifications

※ 12SLOT 10POLES 형식의 모터.

MODEL		BD9S					
		N024100	S024150	N220150	S220200	S220250	S220350
Rated Voltage	V	24			220		
Rated Output	W	100	150	150	200	250	350
Rated Current	A	6.1	10	2	2.3	2.8	3.5
Rated Speed	rpm	3000					
Rated Torque	kgf-cm	3.2	4.8	4.8	6.5	8.1	11.4
Weight	kg	2.2	2.2	2.2	2.2	2.4	2.4
Applicable Drive		SBDM-10A	SBDM-25A	□ SBDSMI-03D SBDSMS-03D			SBDSMD-05D

□ Before placing an order, consult with manufacturer and place of purchase.

The specifications above are subject to change for enhancement of product performance, Without any prior notice.

### Speed-Torque Curve

BD9S-N024100

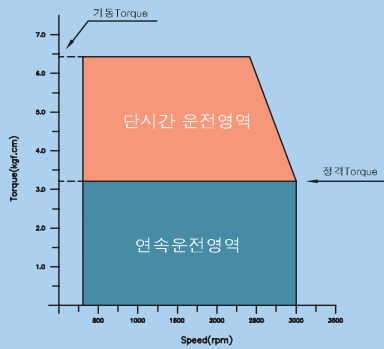

BD9S-S024150

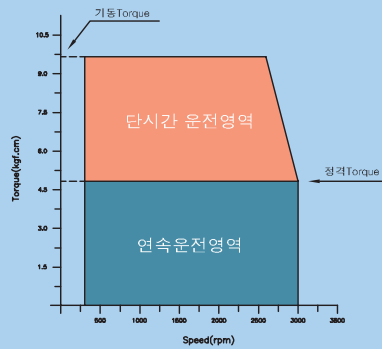

BD9S-N220150

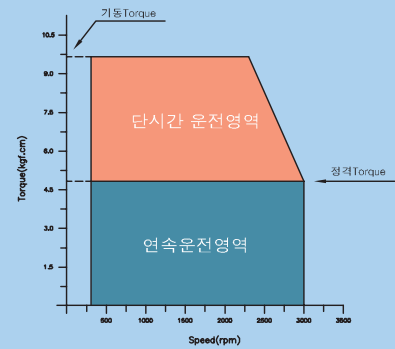

BD9S-S220200

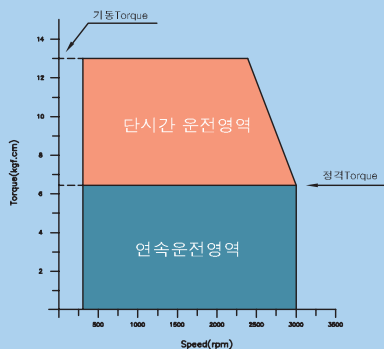

BD9S-S220250

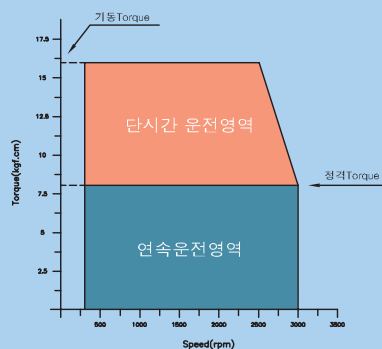

BD9S-S220350

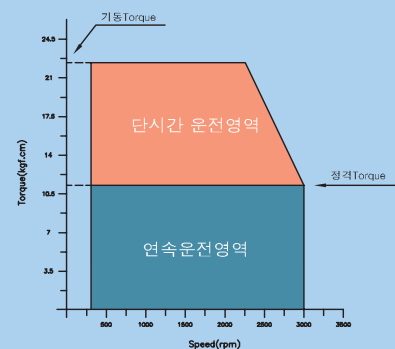

Dimension

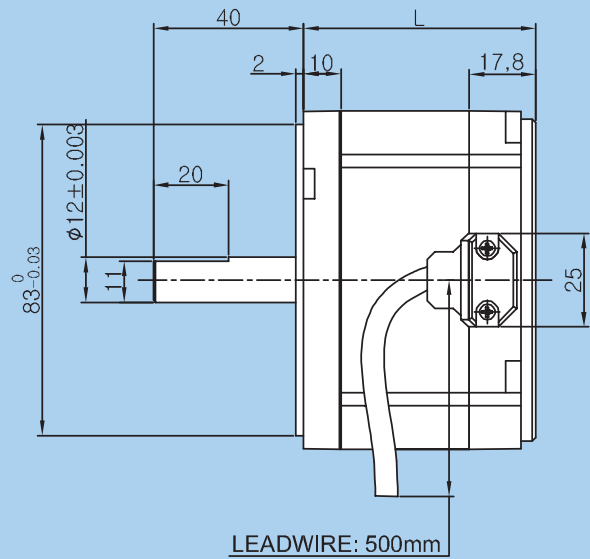
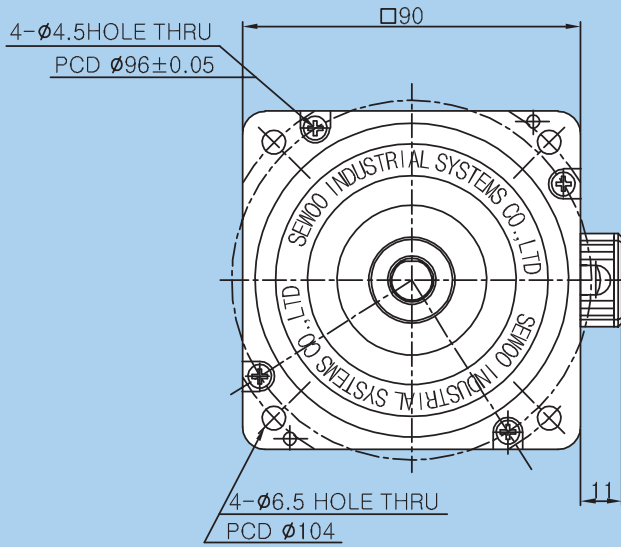

CONNECTOR  
: MOLEX5557-12  
(AC POWER용)

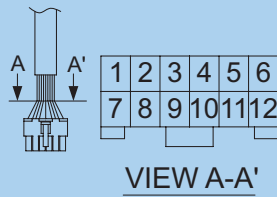

CONNECTOR(5557-12)

PIN No.	Cable Color	LeadWire	Remark
1	BLUE	AWG 20	W
2			
3			
4	BROWN	AWG 24	Hw
5	GREEN	AWG 24	Hv
6	WHITE	AWG 24	Hu
7	YELLOW	AWG 20	V
8	RED	AWG 20	U
9	GRE/YEL	AWG 20	SHIELD
10			
11	ORANGE	AWG 24	Vcc
12	BLACK	AWG 24	GND

CONNECTOR  
: MOLEX 5264-05  
(SBDM-10A/25A)

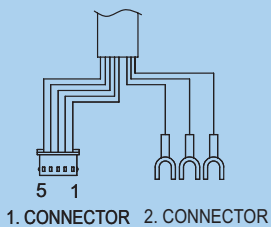

1. CONNECTOR(5264-05)

PIN No.	Cable Color	LeadWire	Remark
1	WHITE	AWG 24	Hu
2	GREEN	AWG 24	Hv
3	BROWN	AWG 24	Hw
4	BLACK	AWG 24	GND
5	ORANGE	AWG 24	Vcc

2. CONNECTOR

PIN No.	Cable Color	LeadWire	Remark
1	RED	AWG 14	U
2	YELLOW	AWG 14	V
3	BLUE	AWG 14	W

L	MODEL
62	N024100 / S024150 / N220150 / S220200
74	S220250 / S220350

# BLDC60 SERIES

## BG60

- ◆ □60mm
- ◆ 12V/24V/220V
- ◆ 10W/15W/20W/40W/50W/60W/80W
- ◆ GEARED TYPE SHAFT



### Specifications

MODEL		BG60								
		N012010	N012015	N012020	N024020	N024040	N024050	N220040	N220060	N220080
Rated Voltage	V	12			24			220		
Rated Output	W	10	15	20	20	40	50	40	60	80
Rated Current	A	1.4	2.1	2.8	1.4	2.3	3.2	0.7	0.9	1.1
Rated Speed	rpm	*15~1000								
Rated Torque	kgf-cm	0.9~30	1.4~30	1.8~30	1.8~30	3.8~30	4.7~30	3.8~30	5.7~30	7.7~30
Weight	kg	0.8	0.9	1.0	0.8	0.9	1.0	0.8	0.9	1.0
Applicable Drive		SBDM-05A						□ SBDSMA-02A □ SBDSMI-03D SBDSMS-03D		

□ Before placing an order, consult with manufacturer and place of purchase.

\* The velocity depends on the rate of the reduction gear.

▶ The specifications above are subject to change for enhancement of product performance, Without any prior notice.

### Dimension

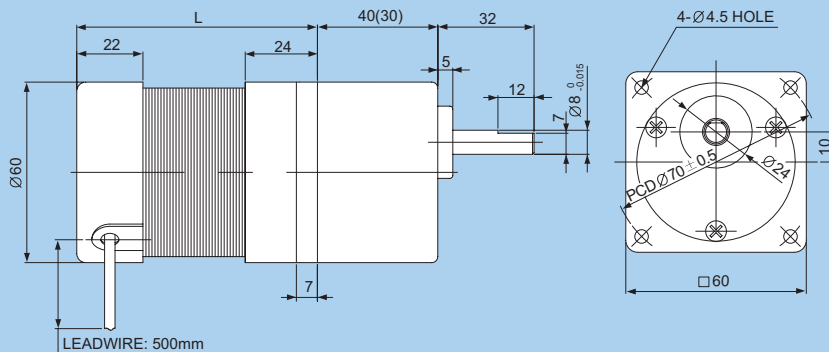

### GEAR HEAD SIZE

GEAR RATIO	SIZE
3 / 1 ~ 18 / 1	30
20 / 1 ~ 200 / 1	40

### CONNECTOR(5557-8)

PIN No.	Cable Color	LeadWire	Remark
1	ORANGE	AWG 24	Vcc
2	RED	AWG 20	U
3	YELLOW	AWG 20	V
4	BLUE	AWG 20	W
5	BLACK	AWG 24	GND
6	WHITE	AWG 24	Hu
7	GREEN	AWG 24	Hv
8	BROWN	AWG 24	Hw

### CONNECTOR(5557-12)

PIN No.	Cable Color	LeadWire	Remark
1	BLUE	AWG 20	W
2			
3			
4	BROWN	AWG 24	Hw
5	GREEN	AWG 24	Hv
6	WHITE	AWG 24	Hu
7	YELLOW	AWG 20	V
8	RED	AWG 20	U
9	GRE/YEL	AWG 20	SHIELD
10			
11	ORANGE	AWG 24	Vcc
12	BLACK	AWG 24	GND

CONNECTOR  
: MOLEX 5557-08  
(SBDM-05A)

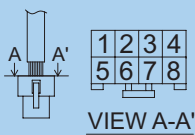

CONNECTOR  
: MOLEX 5557-12  
(AC 전원용)

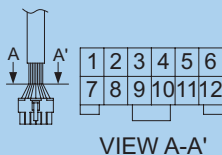

L	MODEL
60	N012010 / N024020 / N220040
70	N012015 / N024040 / N220060
80	N012020 / N024050 / N220080

# BLDC80 SERIES

## BG80

- ◆ □80mm
- ◆ 12V/24V/220V
- ◆ 25W/40W/60W/80W/100W
- ◆ GEARED TYPE SHAFT

밀폐형



기본형

### Specifications

MODEL	BG80										
	N012025	N012040	N012060	N024040	N024060	N024080	N220060	N220080	N220100		
Rated Voltage	V	12			24			220			
Rated Output	W	25	40	60	40	60	80	60	80	100	
Rated Current	A	3.0	4.5	7.0	2.1	3.1	4.2	0.7	0.9	1.1	
Rated Speed	rpm	*15~1000									
Rated Torque	kgf-cm	2.4~80	3.8~80	5.8~80	3.8~80	5.7~80	7.6~30	5.7~80	7.6~80	9.5~80	
Weight	kg	1.9	2.0	2.1	1.9	2.0	2.1	1.9	2.0	2.1	
Applicable Drive		SBDM-05A	SBDM-10A		SBDM-05A		SBDM-10A	□ SBDSMA-02A □ SBDSMI-03D SBDSMS-03D			

□ Before placing an order, consult with manufacturer and place of purchase.

\* The velocity depends on the rate of the reduction gear.

●●●●●▶ The specifications above are subject to change for enhancement of product performance, Without any prior notice.

### Dimension

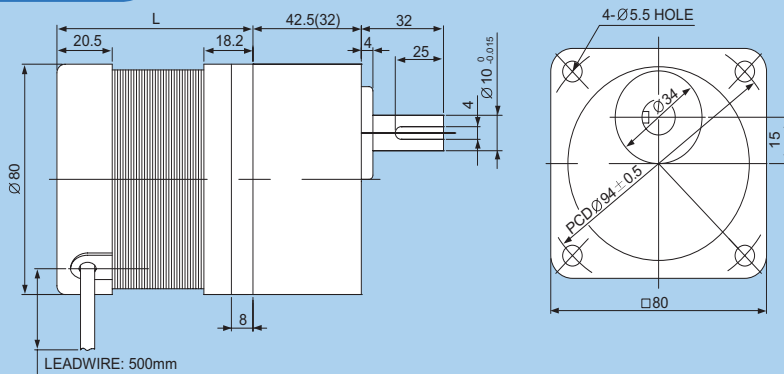

### GEAR HEAD SIZE

GEAR RATIO	SIZE
3 / 1 ~ 18 / 1	32
20 / 1 ~ 200 / 1	42.5

#### CONNECTOR(5557-8)

PIN No.	Cable Color	LeadWire	Remark
1	ORANGE	AWG 24	Vcc
2	RED	AWG 20	U
3	YELLOW	AWG 20	V
4	BLUE	AWG 20	W
5	BLACK	AWG 24	GND
6	WHITE	AWG 24	Hu
7	GREEN	AWG 24	Hv
8	BROWN	AWG 24	Hw

CONNECTOR : MOLEX 5557-08 (SBDM-05A)

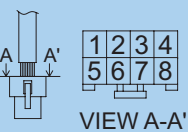

#### CONNECTOR(5557-12)

PIN No.	Cable Color	LeadWire	Remark
1	BLUE	AWG 20	W
2			
3			
4	BROWN	AWG 24	Hw
5	GREEN	AWG 24	Hv
6	WHITE	AWG 24	Hu
7	YELLOW	AWG 20	V
8	RED	AWG 20	U
9	GRE/YEL	AWG 20	SHIELD
10			
11	ORANGE	AWG 24	Vcc
12	BLACK	AWG 24	GND

#### 2. CONNECTOR

PIN No.	Cable Color	LeadWire	Remark
1	RED	AWG 16	U
2	YELLOW	AWG 16	V
3	BLUE	AWG 16	W

#### 1. CONNECTOR(5264-05)

PIN No.	Cable Color	LeadWire	Remark
1	WHITE	AWG 24	Hu
2	GREEN	AWG 24	Hv
3	BROWN	AWG 24	Hw
4	BLACK	AWG 24	GND
5	ORANGE	AWG 24	Vcc

CONNECTOR : MOLEX 5557-12 (AC 전원용)

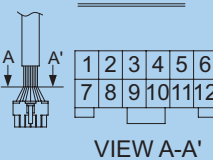

CONNECTOR : MOLEX 5264-05 (SBDM10A)

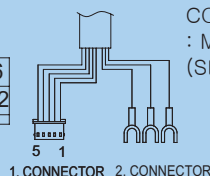

L	MODEL
52.7	N012025 / N024040 / N220060
62.7	N012040 / N024060 / N220080
72.7	N012060 / N024080 / N220100



# BLDC90 SERIES

## BG90 (강력형)

- ◆ □90mm
- ◆ 12V/24V/220V
- ◆ 40W/50W/60W/70W/100W/150W/200W
- ◆ GEARED TYPE SHAFT

밀폐형



기본형

### Specifications

MODEL		BG90 (강력형)							
		N012040	N012060	N012070	N024050	N024100	N024150	N220100	N220150
Rated Voltage	V	12			24			220	
Rated Output	W	40	60	70	50	100	150	100	150
Rated Current	A	5.8	8.5	10	3.0	5.6	8.1	1.0	1.6
Rated Speed	rpm	*15~1000							
Rated Torque	kgf-cm	3.1~200	4.6~200	5.4~200	3.9~200	7.7~200	11.6~200	7.7~200	11.6~200
Weight	kg	3.1	3.3	3.5	3.1	3.3	3.5	3.1	3.3
Applicable Drive		SBDM-10A			SBDM-05A	SBDM-10A	SBDM-25A	□ SBDSMA-02A □ SBDSMI-03D SBDSMS-03D	□ SBDSMI-03D SBDSMS-03D

□ Before placing an order, consult with manufacturer and place of purchase. \* The velocity depends on the rate of the reduction gear.  
 The specifications above are subject to change for enhancement of product performance, Without any prior notice.

### Dimension

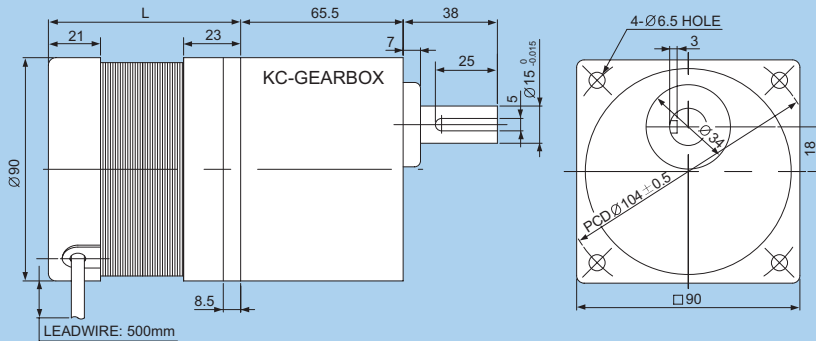

### GEAR HEAD SIZE

GEAR RATIO	SIZE
3 / 1 ~ 200 / 1	65.5

### CONNECTOR(5557-8)

PIN No.	Cable Color	LeadWire	Remark
1	ORANGE	AWG 24	Vcc
2	RED	AWG 20	U
3	YELLOW	AWG 20	V
4	BLUE	AWG 20	W
5	BLACK	AWG 24	GND
6	WHITE	AWG 24	Hu
7	GREEN	AWG 24	Hv
8	BROWN	AWG 24	Hw

CONNECTOR : MOLEX 5557-08 (SBDM-05A)

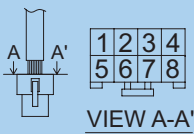

### CONNECTOR(5557-12)

PIN No.	Cable Color	LeadWire	Remark
1	BLUE	AWG 20	W
2			
3			
4	BROWN	AWG 24	Hw
5	GREEN	AWG 24	Hv
6	WHITE	AWG 24	Hu
7	YELLOW	AWG 20	V
8	RED	AWG 20	U
9	GRE/YEL	AWG20	SHIELD
10			
11	ORANGE	AWG 24	Vcc
12	BLACK	AWG 24	GND

CONNECTOR : MOLEX 5557-12 (AC 전원용)

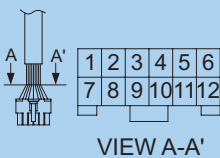

CONNECTOR : MOLEX 5264-05 (SBDM-10A/25A)

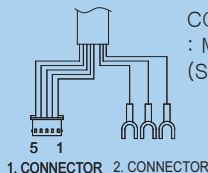

### 2. CONNECTOR

PIN No.	Cable Color	LeadWire	Remark
1	RED	AWG 16	U
2	YELLOW	AWG 16	V
3	BLUE	AWG 16	W

### 1. CONNECTOR(5264-05)

PIN No.	Cable Color	LeadWire	Remark
1	WHITE	AWG 24	Hu
2	GREEN	AWG 24	Hv
3	BROWN	AWG 24	Hw
4	BLACK	AWG 24	GND
5	ORANGE	AWG 24	Vcc

L	MODEL
57.5	N012040 / N024050 / N220100
67.5	N012060 / N024100 / N220150
77.5	N012070 / N024150

# BLDC90 SERIES

## BG90 (초강력형)

- ◆ □90mm
- ◆ 24V/220V
- ◆ 40W/50W/60W/70W/100W/150W/200W
- ◆ GEARED TYPE SHAFT

밀폐형

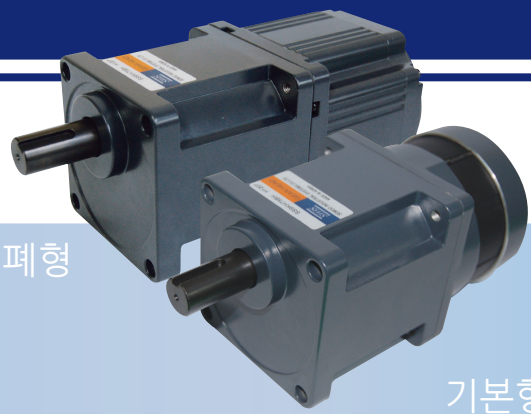

기본형

### Specifications

MODEL		BG90 (초강력형)		
		N024150	N220150	N220200
Rated Voltage	V	24	220	
Rated Output	W	150	150	200
Rated Current	A	8.1	1.6	2.1
Rated Speed	rpm	*15~1000		
Rated Torque	kgf-cm	11.6~300	11.6~300	15.4~300
Weight	kg	3.8	3.6	3.8
Applicable Drive		SBDM-25A	□ SBDSMI-03D SBDSMS-03D	

□ Before placing an order, consult with manufacturer and place of purchase. \* The velocity depends on the rate of the reduction gear.

▶ The specifications above are subject to change for enhancement of product performance, Without any prior notice.

### Dimension

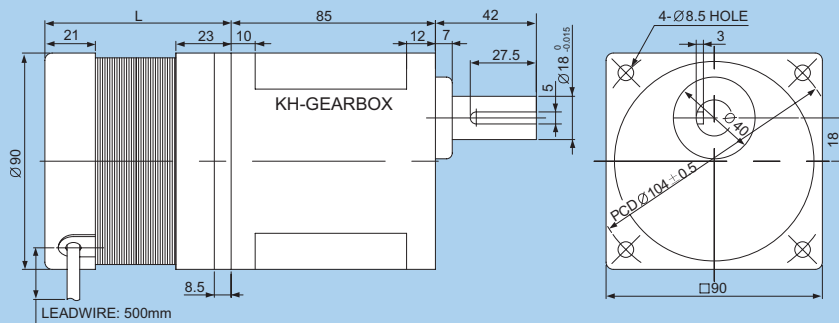

### GEAR HEAD SIZE

GEAR RATIO	SIZE
3 / 1 ~ 200 / 1	85

### CONNECTOR(5557-12)

PIN No.	Cable Color	LeadWire	Remark
1	BLUE	AWG 20	W
2			
3			
4	BROWN	AWG 24	Hw
5	GREEN	AWG 24	Hv
6	WHITE	AWG 24	Hu
7	YELLOW	AWG 20	V
8	RED	AWG 20	U
9	GRE/YEL	AWG20	SHIELD
10			
11	ORANGE	AWG 24	Vcc
12	BLACK	AWG 24	GND

### 2. CONNECTOR

PIN No.	Cable Color	LeadWire	Remark
1	RED	AWG 16	U
2	YELLOW	AWG 16	V
3	BLUE	AWG 16	W

### 1. CONNECTOR(5264-05)

PIN No.	Cable Color	LeadWire	Remark
1	WHITE	AWG 24	Hu
2	GREEN	AWG 24	Hv
3	BROWN	AWG 24	Hw
4	BLACK	AWG 24	GND
5	ORANGE	AWG 24	Vcc

CONNECTOR : MOLEX 5264-05 (SBDM-25A)

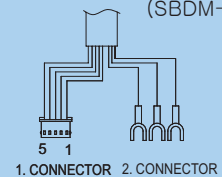

1. CONNECTOR 2. CONNECTOR

CONNECTOR : MOLEX 5557-12 (AC 전원용)

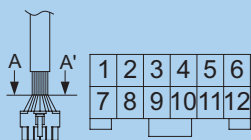

VIEW A-A'

L	MODEL
67.5	N220150
77.5	N024150 / N220200

# BLDC90 SERIES

## BG9S(강력형, 초강력형)

- ◆ □90mm
- ◆ 24V/220V
- ◆ 100W/150W/200W/250W/350W
- ◆ GEARED TYPE SHAFT

강력형

초강력형



### Specifications

MODEL		BG9S(강력형)			BG9S(초강력형)				
		N024100	S024150	N220150	S024150	N220150	S220200	S220250	S220350
Rated Voltage	V	24		220	24	220			
Rated Output	W	100	150	150	150	150	200	250	350
Rated Current	A	6.1	10	2	10	2	2.3	2.8	3.5
Rated Speed	rpm	*15~1000							
Rated Torque	kgf-cm	7.7~200	11.6~200	11.6~200	11.6~300	11.6~300	15.4~300	19.4~300	27.4~300
Weight	kg	2.2	2.2	2.2	2.2	2.2	2.2	2.4	2.4
Applicable Drive		SBDM-10A	SBDM-25A	□ SBDSMI-03D SBDSMS-03D	SBDM-25A	□ SBDSMI-03D SBDSMS-03D			SBDSMD-05D

□ Before placing an order, consult with manufacturer and place of purchase. \* The velocity depends on the rate of the reduction gear.

▶ The specifications above are subject to change for enhancement of product performance, Without any prior notice.

### Dimension

\* Gear ratio : 3/1~200/1

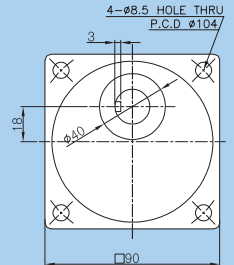
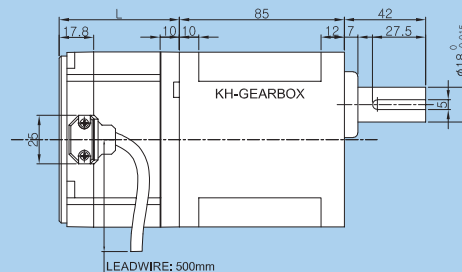
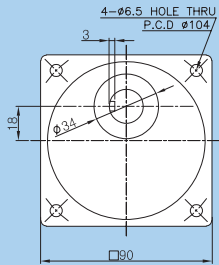
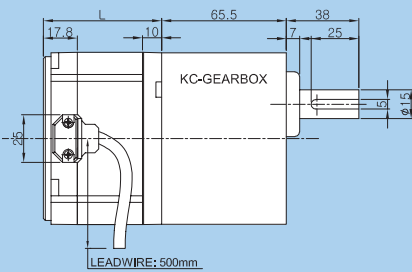

#### CONNECTOR(5557-12)

PIN No.	Cable Color	LeadWire	Remark
1	BLUE	AWG 20	W
2			
3			
4	BROWN	AWG 24	Hw
5	GREEN	AWG 24	Hv
6	WHITE	AWG 24	Hu
7	YELLOW	AWG 20	V
8	RED	AWG 20	U
9	GRE/YEL	AWG20	SHIELD
10			
11	ORANGE	AWG 24	Vcc
12	BLACK	AWG 24	GND

#### 2. CONNECTOR

PIN No.	Cable Color	LeadWire	Remark
1	RED	AWG 16	U
2	YELLOW	AWG 16	V
3	BLUE	AWG 16	W

#### 1. CONNECTOR(5264-05)

PIN No.	Cable Color	LeadWire	Remark
1	WHITE	AWG 24	Hu
2	GREEN	AWG 24	Hv
3	BROWN	AWG 24	Hw
4	BLACK	AWG 24	GND
5	ORANGE	AWG 24	Vcc

CONNECTOR : MOLEX 5264-05 (SBDM-10A/25A)

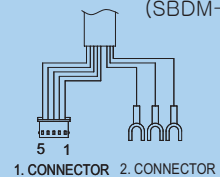

CONNECTOR : MOLEX 5557-12 (AC 전원용)

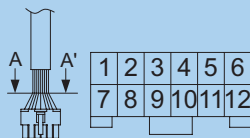

VIEW A-A'

L	MODEL
62	N024100 / S024150 / N220150 / S220200
74	S220250 / S220350